

JOHN DEERE
WORLDWIDE COMMERCIAL & CONSUMER
EQUIPMENT DIVISION

Mounted Sprayers
15, 25 and 40 Gallon

OMM155667 D6

OPERATOR'S MANUAL



JOHN DEERE

All information, illustrations and specifications in this manual are based on the latest information at the time of publication. The right is reserved to make changes at any time without notice.

COPYRIGHT© 2006
Deere & Co.

John Deere Worldwide Commercial and
Consumer Equipment Division
All rights reserved
Previous Editions
COPYRIGHT©

North American Version
Litho in U.S.A.

INTRODUCTION

Introduction

Using Your Operator's Manual

Read this entire operator's manual, especially the safety information, before operating.

This manual is an important part of your machine. Keep all manuals in a convenient location so they can be accessed easily.

Use the safety and operating information in the attachment operator's manual, along with the machine operator's manual, to operate and service the attachment safely and correctly.

If your attachment manual has a section called Preparing the Machine, it means that you will have to do something to your tractor or vehicle before you can install the attachment. The Assembly and Installation sections of this manual provide information to assemble and install the attachment to your tractor or vehicle. Use the Service section to make any needed adjustments and routine service to your attachment.

If you have any questions or concerns with the assembly, installation, or operation of this attachment, see your local John Deere dealer or call the John Deere Customer Contact Center at 1-800-537-8233 for assistance.

Warranty information on this John Deere attachment can be found in the warranty that came with your John Deere tractor or vehicle.

Product Identification

Product Compatibility

The 15 Gallon Sprayer is compatible with the Utility All Terrain Vehicles.

The 25 Gallon Sprayer is compatible with the Utility Vehicles and Utility All Terrain Vehicles with a cargo box.

The 40 Gallon Sprayer is compatible with the Traditional and High Performance Series Utility Vehicles.

Safety

Read the general safety operating precautions in your machine operator's manual for additional safety information.

Operate Safely

- Read the machine and attachment operator's manual carefully. Be thoroughly familiar with the controls and the proper use of the equipment. Know how to stop the machine and disengage the controls quickly.
- Do not let children or an untrained person operate machine.
- Make any necessary adjustments before you operate. Never attempt to make any adjustments while the engine is running, unless if recommended in adjustment procedure.
- Take all possible precautions when leaving the machine unattended. Shut off the engine before making any repairs, adjustments, or inspections. Lower the attachment, lock the parking brake, stop the engine, and remove the key.
- Look behind machine before you back up. Back up carefully.
- Do not let anyone, especially children, ride on machine or attachment. Riders are subject to injury such as being struck by foreign objects and being thrown off. Riders may also obstruct the operator's view, resulting in the machine being operated in an unsafe manner.
- Use only attachments and accessories approved by the manufacturer of this product.

- If the machine vibrates abnormally, stop the engine and check immediately for the cause. Vibration is generally a warning of trouble.
- Always refer to the Storage section of the operator's manual for important details if storing this product for a long period of time.
- Keep people and pets out of the work area. Stop machine if anyone enters the area.
- If you hit an object, stop the machine and inspect it. Make repairs before you operate. Keep machine properly maintained and in good working order. Keep all shields and guards in place.
- Always inspect the sprayer completely before and after each use. Before pressurizing the system, check to be sure all fittings and hoses are tightly installed. Be sure guards and shields are in good condition and fastened in place. Make any necessary adjustments before you operate.
- Never use the sprayer during windy conditions.
- Always release pressure in the system before filling, cleaning or servicing the sprayer.
- Do not put nozzle tip or other sprayer parts to your lips to blow out dirt. Use compressed air.
- If the sprayer is mounted to the bed of a utility vehicle, never raise the bed with the sprayer installed. Empty the sprayer and remove it from the bed if you need to raise the bed for any reason.

Parking Safely

1. Stop vehicle on a level surface, not on a slope.
2. Lock park brake.
3. Stop engine.
4. Remove key.
5. Before you leave the operator's seat, wait for engine and all moving parts to stop.
6. Disconnect the negative battery cable or remove the spark plug wire (for gasoline engines) before servicing the machine.

Mix and Handle Chemicals Safely

- It is best to wear full cover clothing and always wear protective goggles and rubber gloves to protect yourself while handling chemicals.
- Follow instructions on chemical container labels.
- Open all chemical containers carefully, using proper tools.
- Open, pour, weigh and mix chemicals in a well-ventilated area.
- Reserve all equipment used for the application of chemicals exclusively for that purpose.
- Prohibit all smoking, drinking and eating food in chemical-handling area.
- It is a good practice to take a soapy shower immediately after the using the sprayer to apply chemicals.
- Wash all clothing worn when using chemicals separately in the laundry after spraying is completed.

Read Chemical Container Label

- Chemicals can be dangerous. Improper selection or use can injure persons, animals, plants, soils or other property. Select the right chemical for the job and handle and apply with care.
- Read the instructions, precautions, and warnings on the container label before opening. Use the product strictly according to label directions for specific applications, in the amounts specified, at the times specified and only when needed.

SAFETY

- Keep the container closed tightly except when preparing the mix.
- Do not remove labels from chemical containers. Store all chemicals in their original containers.
- Do not mix chemicals unless stated on the container label.
- Store chemicals when not in use according to the container label.

Handle Chemical Products Safely

- Direct exposure to hazardous chemicals can cause serious injury. Potentially hazardous chemicals used with John Deere equipment include pesticides, herbicides and fungicides.
- A Material Safety Data Sheet (MSDS) provides specific details on chemical products: physical and health hazards, safety procedures, and emergency response techniques.
- The MSDS should be obtained from the chemical dealer at the time of the chemical purchase.
- Check the MSDS before beginning any job using a hazardous chemical. Know exactly what the risks are and how to do the job safely. Always wear recommended personal protection equipment.

Practice Safe Maintenance

- Only qualified, trained adults should service this machine.
- Understand service procedure before doing work. Keep area clean and dry.
- Do not operate the engine in a confined space where dangerous carbon monoxide fumes can collect.
- Never lubricate, service or adjust the machine or attachment while it is moving. Keep safety devices in place and in working condition. Keep hardware tight.
- Keep hands, feet, clothing, jewelry, and long hair away from any moving parts, to prevent them from getting caught.
- Lower any attachment completely to the ground or to an existing attachment mechanical stop before servicing the attachment. Disengage all power and stop the engine. Lock park brake and remove the key. Let machine cool.
- Disconnect battery or remove spark plug wire (for gasoline engines) before making any repairs.
- Before servicing machine or attachment, carefully release pressure from any components with stored energy, such as hydraulic components and springs.
- Release hydraulic pressure by lowering attachment or cutting units to the ground or to a mechanical stop and move hydraulic control levers.
- Securely support any machine or attachment elements that must be raised for service work. Use jack stands or lock service latches to support components when needed.
- Never run engine unless park brake is locked.
- Keep all parts in good condition and properly installed. Fix damage immediately. Replace worn or broken parts. Replace all worn or damaged safety and instruction decals.
- Check all hardware at frequent intervals to be sure the equipment is in safe working condition.
- Do not modify machine or safety devices. Unauthorized modifications to the machine or attachment may impair its function and safety.

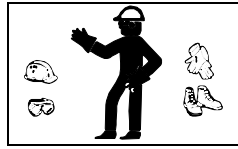

Wear Appropriate Clothing

- Wear close fitting clothing and safety equipment appropriate for the job.
- Certain operating conditions may dictate that the operator and any passenger wear appropriate safety equipment while operating the vehicle. Be prepared for any existing and potential conditions before operating machine.
- Local safety or insurance regulations may require additional safety equipment such as eye protection or a hard hat.
- Always wear substantial footwear and long trousers. Do not operate the equipment when barefoot or wearing open sandals.
- Wear proper clothing and safety equipment while handling chemicals or using the sprayer. Refer to the MSDS for the chemicals being used to be sure the proper personal protection equipment is being used.



Avoid High Pressure Fluids

- Hydraulic hoses and lines can fail due to physical damage, kinks, age, and exposure. Check hoses and lines regularly. Replace damaged hoses and lines.
- Hydraulic fluid connections can loosen due to physical damage and vibration. Check connections regularly. Tighten loose connections.
- Escaping fluid under pressure can penetrate the skin causing serious injury. Avoid the hazard by relieving pressure before disconnecting hydraulic or other lines. Tighten all connections before applying pressure.
- Search for leaks with a piece of cardboard. Protect hands and body from high pressure fluids.
- If an accident occurs, see a doctor immediately. Any fluid injected into the skin must be surgically removed within a few hours or gangrene may result. Doctors unfamiliar with this type of injury should reference a knowledgeable medical source. Such information is available from Deere & Company Medical Department in Moline, Illinois, U.S.A. Information may be obtained in the United States and Canada only by calling 1-800-822-8262.

Dispose of Chemicals Properly

- Proper disposal of excess spray material is very important. If you have excess tank solution, it is best to dilute it with water and apply it to the area you previously treated.
- Never dump solution into a drain or near a lake or stream.
- Chemicals containers should be triple-rinsed, with the rinse water added to the sprayer tank. Do not burn empty chemical containers. Dispose of containers at recycling centers.

Handling Waste Product and Chemicals

Waste products, such as, used oil, fuel, coolant, brake fluid, and batteries, can harm the environment and people:

- Do not use beverage containers for waste fluids - someone may drink from them.
- See your local Recycling Center or authorized dealer to learn how to recycle or get rid of waste products.
- A Material Safety Data Sheet (MSDS) provides specific details on chemical products: physical and health hazards, safety procedures, and emergency response techniques. The seller of the chemical products used with your machine is responsible for providing the MSDS for that product.

ASSEMBLY

G- (2) Boom Extensions

Assembly

Identify Parts - 15 Gallon Sprayer

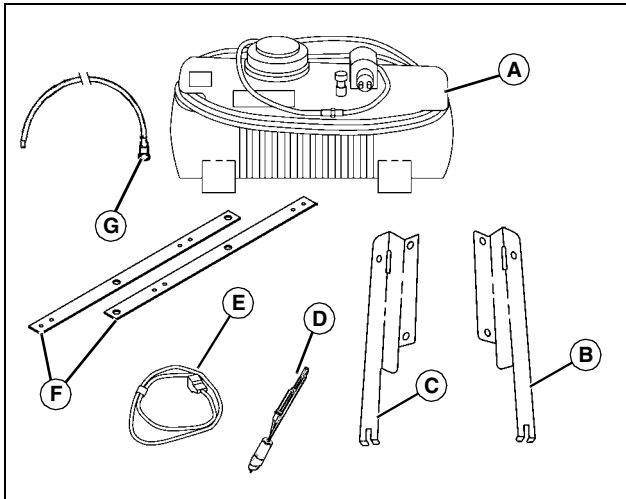

MX35103

A- 15 Gallon Sprayer Base Unit (Tank with pump and hoses attached)

B- Z Bracket, Right

C- Z Bracket, Left

D- 12 Volt Plug Adapter Harness

E- Wiring Harness, Main

F- (2) Boom Extensions

G- Hose, Connection

Identify Parts - 25 and 40 Gallon Sprayer

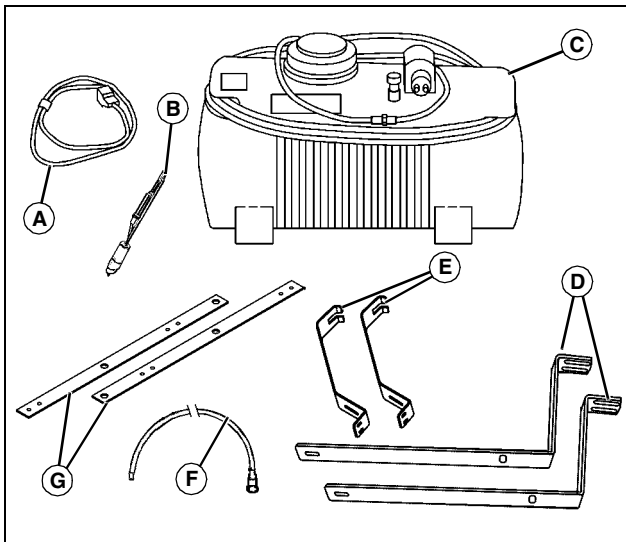

MX35104

A- Wiring Harness, Main

B- 12 Volt Plug Adapter Harness

C- 25 and 40 Gallon Sprayer Base Unit (Tank with pump and hoses attached)

D- (2) Bracket, Tank Mount

E- (2) Bracket, Rear Boom Support

F- Hose, Connection

Bag of Parts (15, 25 and 40 Gallon Sprayers)

Part Description	15 Gal	25/40 Gal
Bolt, Flange, 5/16 x 1 in.	4	2
Washer, 5/16 in.	16	-
Bolt, Flange, 5/16 x 3/4 in.	-	8
Carriage Bolt, 5/16 x 3/4 in.	-	4
Flange Nut, 5/16 in.	-	8
Carriage Bolt, 3/8 in.	2	4
Lockwasher, 3/8 in.	2	4
Washer, Flat, 3/8 in.	-	2
Locking Knob	2	4
Rubber Bumper	4	8
Wire Clip	4	2
Spray Tip	3	3
Spray Tip Screen	3	3
Spray Tip Fitting Locknut	3	3
Spray Tip Fitting Cap Nut	3	3

Clean Sprayer Tank

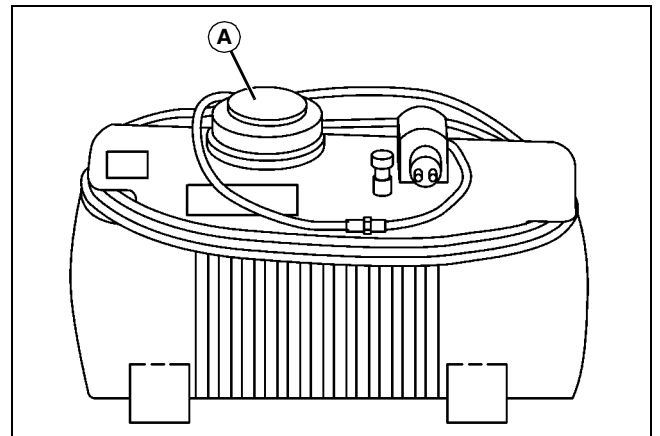

MX34800

1. Remove tank filler cap (A).
2. Remove hardware bags and wiring harness from inside tank.
3. Spray over all inside surfaces of tank with low pressure garden hose.
4. Skim all plastic shavings or other debris from the water.
5. Once clean, empty the tank and install filler cap.

ASSEMBLY

Assemble Sprayer Tank - 15 Gallon

15 Gallon Sprayer

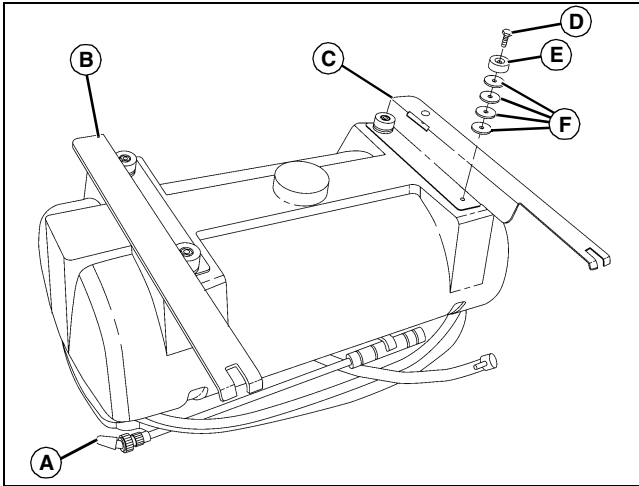

MX35105

1. Invert the sprayer tank so it is supported on a work table, and the spray wand (A) is on the side you are working on.
2. Install the left (B) and right (C) Z brackets, with the extensions to the outside of tank and facing towards you as you install them. Secure with 5/16x1 in. flange bolts (D), rubber bumpers (E), and four 5/16 in. washers (F) with each bolt, as shown. Turn rubber bumpers finger tight.
3. Check placement of Z brackets so they fit tight against the rear rack tubing, then finger tighten the bumpers and washers.

Assemble Sprayer Tank - 25 Gallon

25 Gallon Sprayer for Compact Series Gators and EXT Model UATV

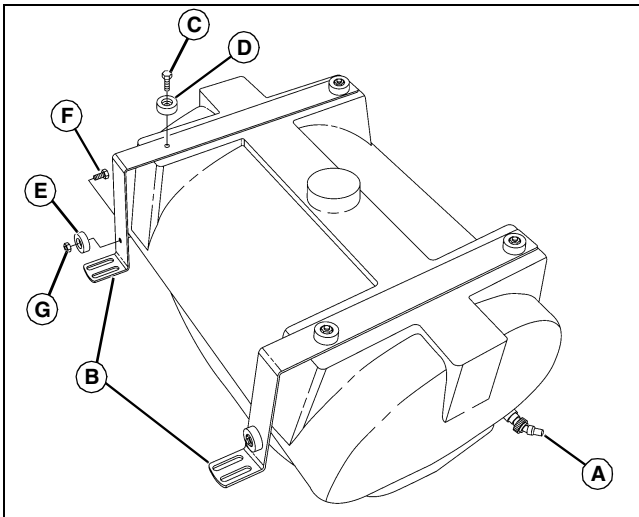

MX35106

1. Invert the sprayer tank so it is supported on a work table, and the spray wand (A) is opposite the side you are working on.
2. Install the two main supports (B) using four 5/16x3/4 in. flange bolts (C) along with rubber bumpers (D). Turn rubber bumpers finger tight.
3. Install two rubber bumpers (E) onto front side of main supports using two 5/16 x 3/4 in. bolts (F) and 5/16 in. flange nuts (G).

Assemble Sprayer Tank - 25 and 40 Gallon

25 and 40 Gallon Sprayer for Traditional and High Performance Series Gators

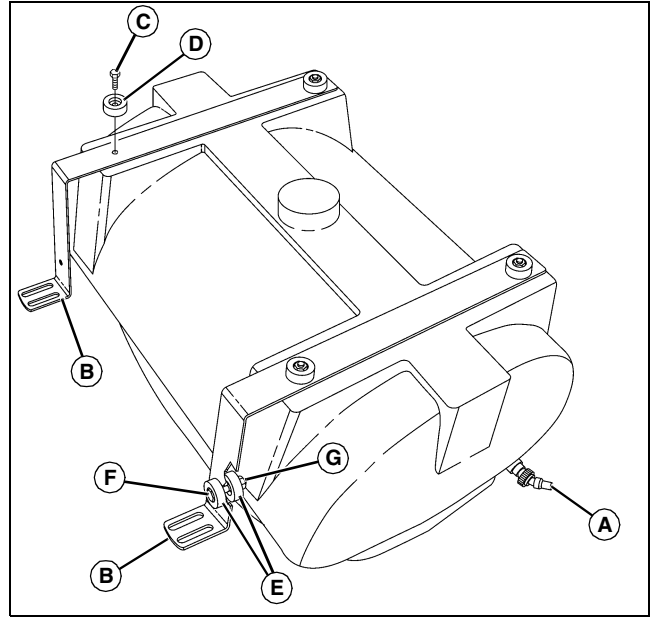

MX37761

1. Invert the sprayer tank so it is supported on a work table, and the spray wand (A) is opposite the side you are working on.
2. Install the two main supports (B) using four 5/16x3/4 in. flange bolts (C) along with rubber bumpers (D). Turn rubber bumpers finger tight.
3. Install two rubber bumpers (E) onto each side of main support using a 5/16 x 1 in. bolt (F) and 5/16 in. flange nut (G), with nut on the tank side. Repeat for opposite side main support.

Assemble Sprayer Boom

Assemble Boom Extensions

15 Gallon Sprayer

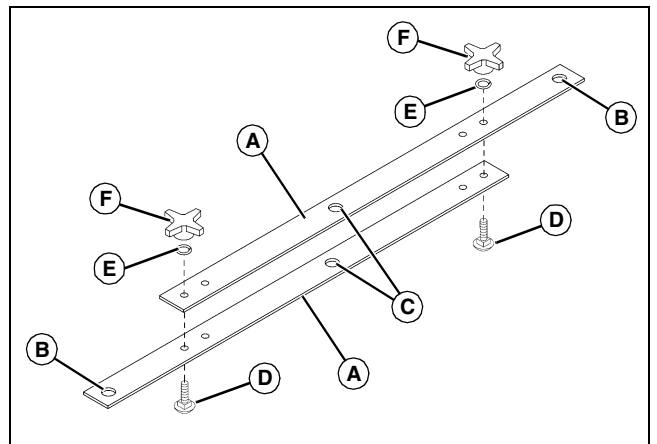

MX35107

1. Assemble sprayer boom extensions (A), with two large holes (B) at each end, and brackets overlapping for the center hole (C). Install two 3/8 in. carriage bolts (D) into outer holes from the bottom, and on top two lockwashers (E), and locking knobs (F).

ASSEMBLY

25 and 40 Gallon Sprayer

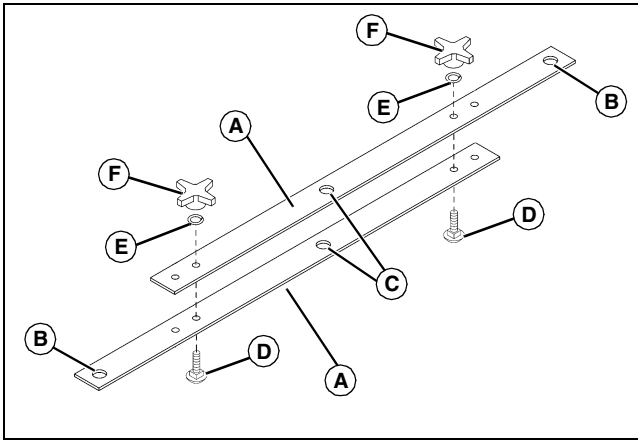

MX35108

1. Assemble sprayer boom extensions (A), with two large holes (B) at each end, and brackets overlapping for the center hole (C). Install two 3/8 in. carriage bolts (D) into inner holes from the bottom, and on top two lockwashers (E), and locking knobs (F).

Install Hoses

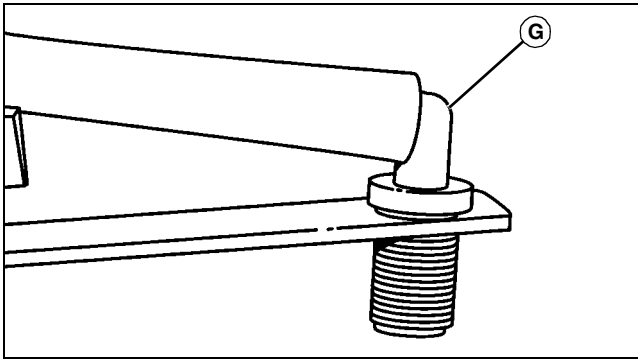

MX34798

1. Install hose fitting (G) into all three boom holes.

NOTE: Prior to tightening the spray tip fitting cap nuts, make sure center spray tip is parallel with boom, and the outer two spray tips are angled out 30 degrees.

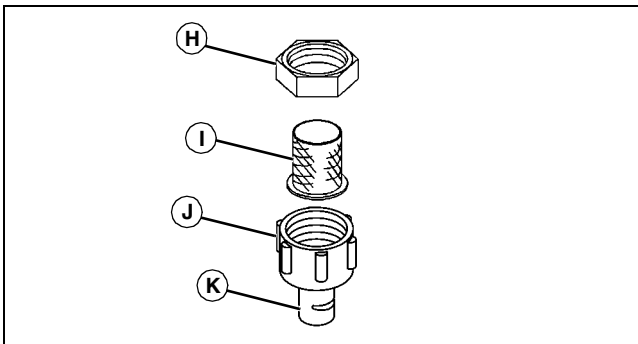

MX35109

2. Install spray tips:

- Spray Tip Fitting Locknut (H)
- Spray Tip Screen (I)
- Spray Tip Fitting Cap Nut (J)
- Spray Tip (K)

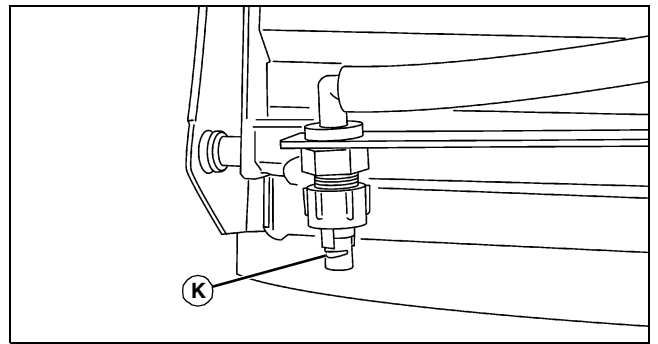

MX35119

3. Check spray tips:

- Center spray tip should be aligned with boom, and spray straight back from boom.
- Outer two spray tips (K) should be angled out 30 degrees, as shown.

Install Wire Clips

15 Gallon Sprayer

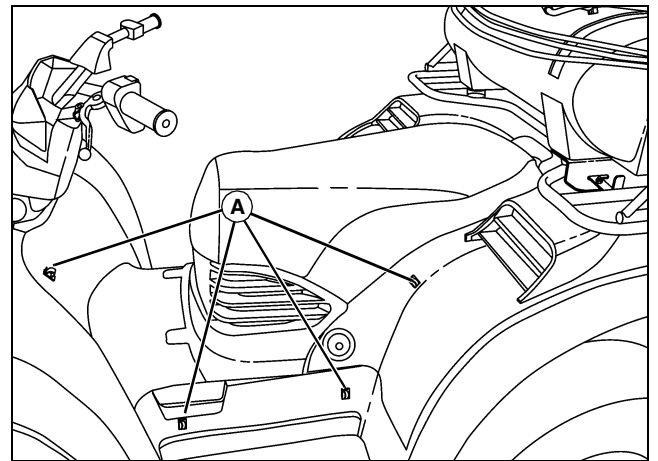

MX35110

1. Clean areas of vehicle where clips are to be mounted with mild detergent or isopropyl alcohol. Dry thoroughly.
2. Attach four wire clips (A) to panels. Position the clips as shown so that sprayer main wiring harness will not interfere with operator access/egress or operation.

INSTALLING

25 and 40 Gallon Sprayer

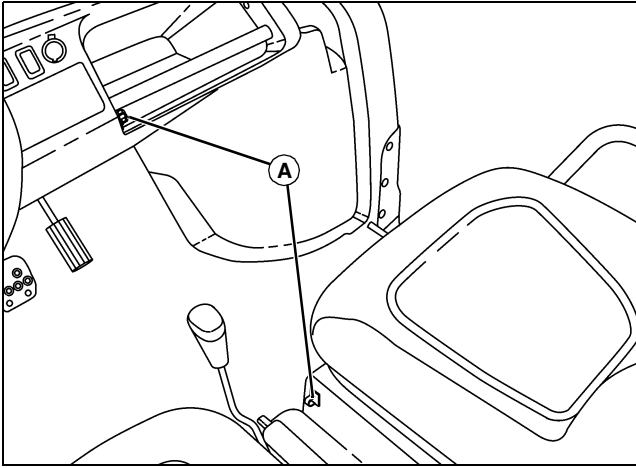

MX35111

1. Clean areas of vehicle where clips are to be mounted with mild detergent or isopropyl alcohol. Dry thoroughly.
2. Attach two wire clips (A) to panels. Position the clips as shown so that sprayer main wiring harness will not interfere with operator access/egress or operation.

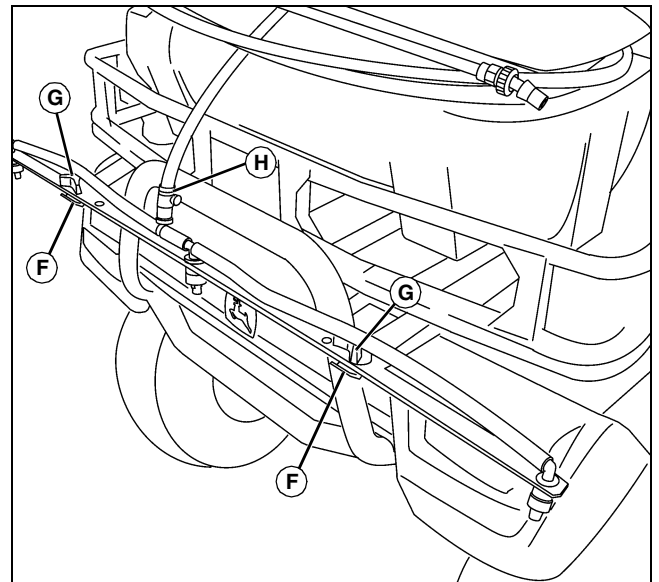

MX35113

3. Install sprayer boom assembly onto Z brackets (F), with carriage bolt secured in fork area of Z bracket. Tighten locking knobs (G) to secure into position.
4. Install sprayer hose (H) onto center coupling on boom assembly hose.

Installing

Install Sprayer - 15 Gallon Sprayer

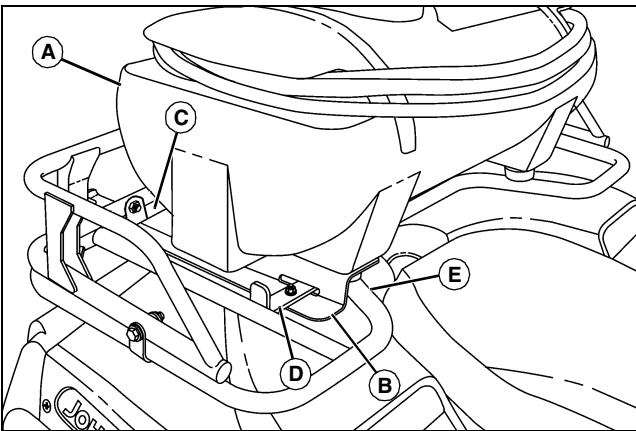

MX35112

1. Install sprayer tank assembly (A) onto rear rack so rear of Z bracket (B) goes under rear tube (C) of rear rack. (Push sprayer tank assembly all the way towards the rear until flange of Z bracket hits rear tube (C).)
2. Turn lever (D) parallel with tank, securing front side of tank onto front side rear rack tube (E).

Install Sprayer - 25 Gallon Sprayer

25 Gallon Sprayer for Compact Series Gators and EXT Model UATV

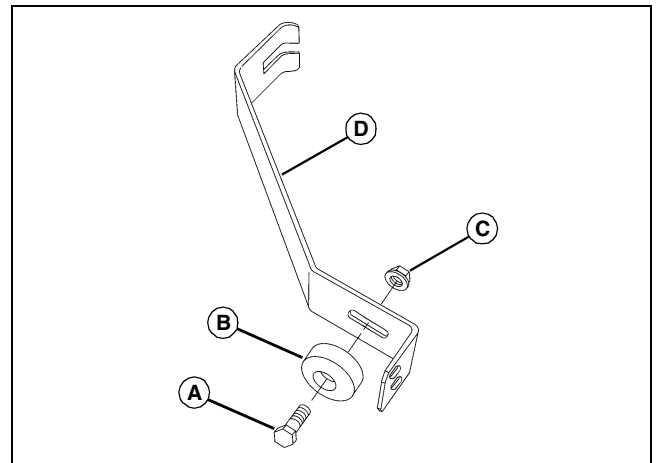

MX35114

1. Install 5/16x3/4 in. flange bolt (A), rubber bumper (B), and 5/16 in. flange nut (C) onto rear boom support bracket (D), as shown. (Do not tighten hardware at this time.) Repeat for second boom support bracket.

INSTALLING

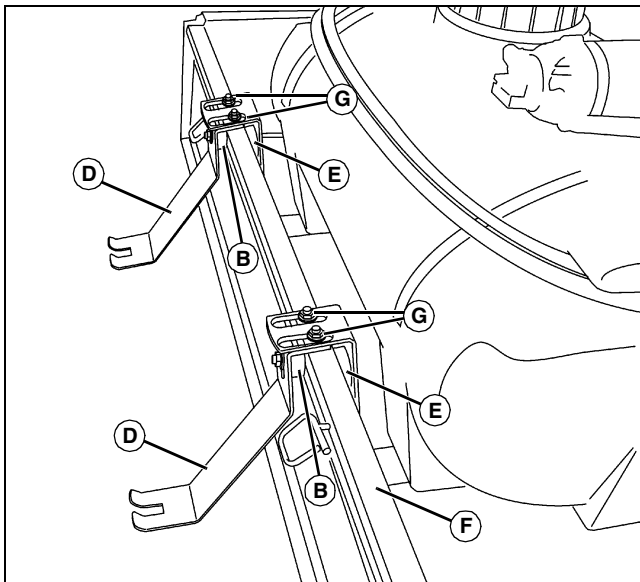

MX35115

2. Raise sprayer assembly into cargo box, with two bumpers (E) resting against tailgate (F).

NOTE: Boom support brackets (D) should be adjusted based on specific vehicle used.

3. Install boom support brackets (D), with bumpers (B) resting against rear side of tailgate, and secure brackets with two 5/16x3/4 in. carriage bolts, and 5/16 in. flange nuts (G) on each side. Do not tighten hardware at this time.

4. Adjust bumpers (B) up and down to secure against a flat surface on tailgate, and tighten bumpers. Adjust brackets (D) tight up against tailgate on both sides, and tighten two 5/16 in. flange nuts (G) on each side.

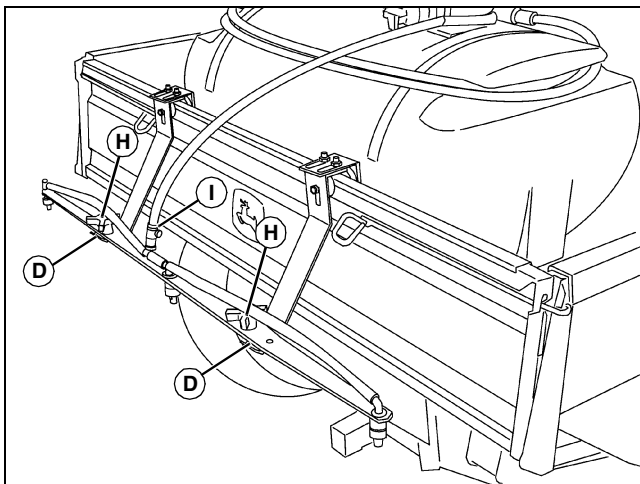

MX35116

5. Install sprayer boom assembly onto boom support brackets (D), with carriage bolt secured in fork area of Z bracket. Tighten locking knobs (H) to secure into position.

6. Install sprayer hose (I) onto center coupling on boom assembly hose.

Install Sprayer - 25 and 40 Gallon Sprayer

25 and 40 Gallon Sprayer for Traditional and High Performance Series Gators

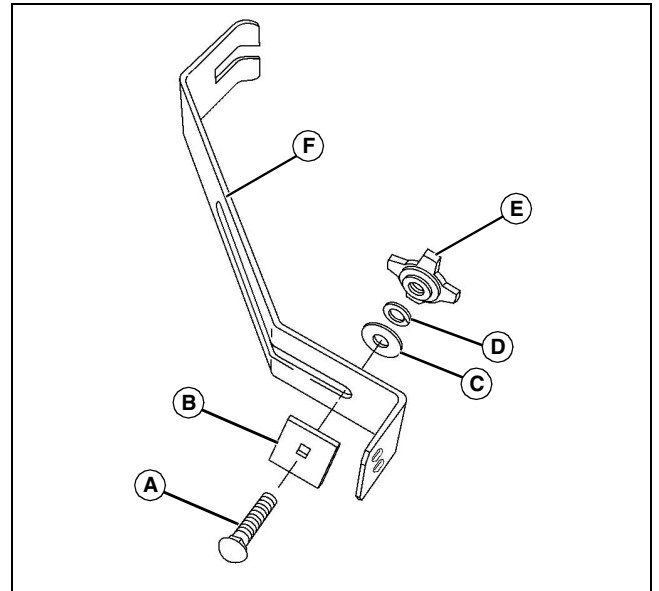

MX37762

1. Install 3/8 in. carriage bolt (A), square backing plate (B), 3/8 in. flat washer (C), 3/8 in. lockwasher (D), and locking knob (E) onto rear boom support bracket (F), as shown. (Do not tighten hardware at this time.) Repeat for second boom support bracket.

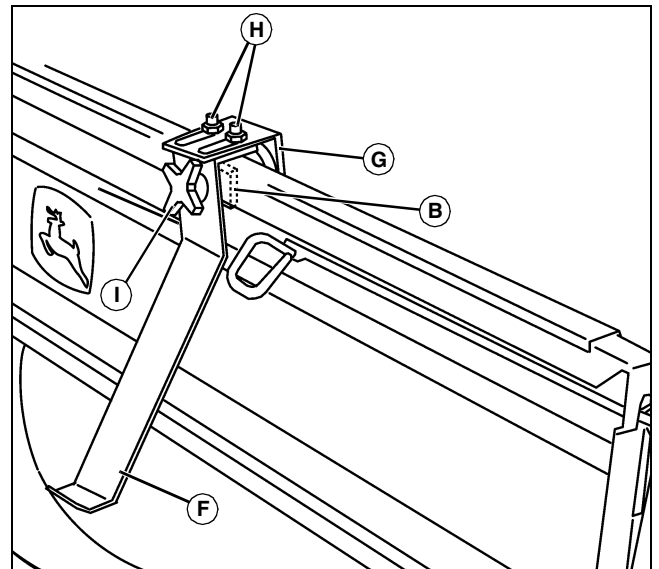

MX37763

2. Attach the rear boom support brackets (F) to the main tank supports (G) using four 5/16x3/4 in. carriage bolts (H), and 5/16 in. flange nuts on each side. Move the boom support brackets as far forward as possible and tighten flange nuts on carriage bolts.

3. Raise sprayer assembly into cargo box. Move sprayer rearward until the rubber bumpers are against the tailgate. Raise the locking knob on the rear of the bracket upward until the square backing plate (B) is behind the tailgate. Tighten locking knob to secure the unit in place. Repeat for second boom support bracket.

PREPARING VEHICLE

Install Wiring Harness - 15 Gallon Sprayer

NOTE: Switch (A) is not located at center of main wiring harness. The harness plug connector nearest to the switch gets connected to the pump leads.

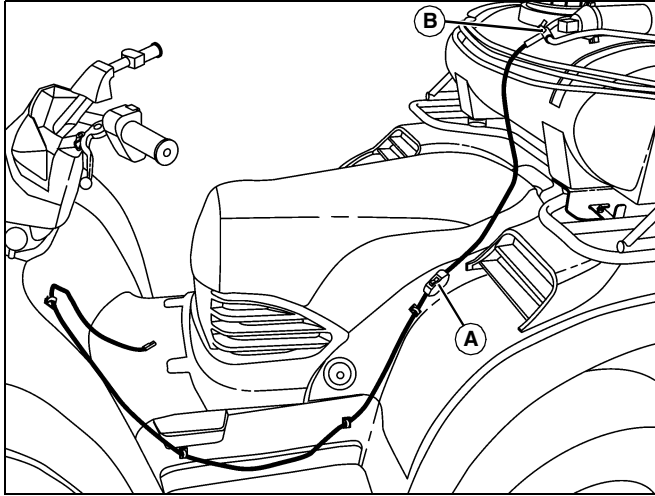

MX35117

1. Connect main wiring harness to pump leads (B).
2. Route main harness as shown and clip in place.

IMPORTANT: Avoid damage! Avoid damage to wiring. Keep wiring harnesses away from all moving parts and hot surfaces.

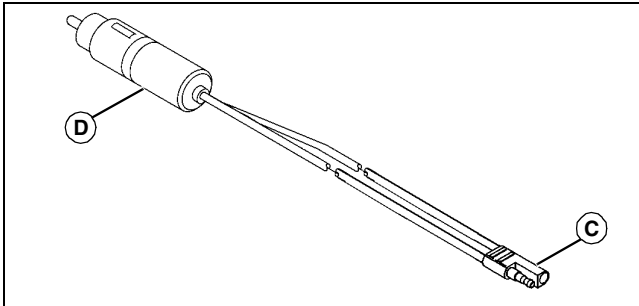

MX35122

3. Connect other end of main harness to 12 volt plug adapter harness (C), and plug 12 volt plug (D) into accessory outlet on instrument panel.

Install Wiring Harness - 25 and 40 Gallon Sprayer

NOTE: Switch (A) is not located at center of main wiring harness. The harness plug connector furthest from the switch gets connected to the pump leads.

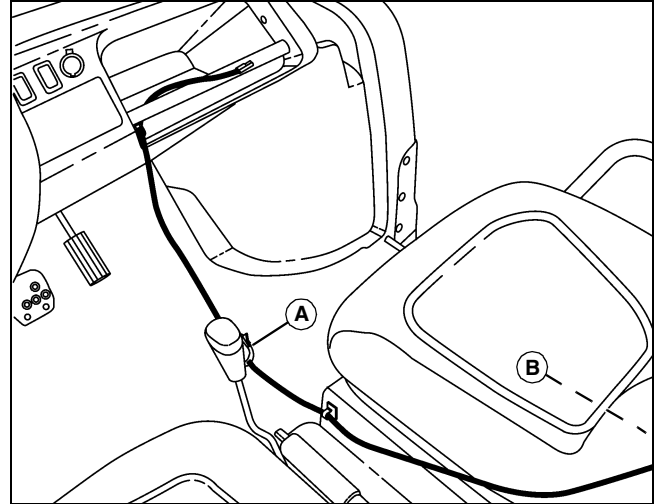

MX35118

1. Connect main wiring harness to pump leads (B).
2. Route main harness as shown and clip in place.

IMPORTANT: Avoid damage! Avoid damage to wiring. Keep wiring harnesses away from all moving parts and hot surfaces.

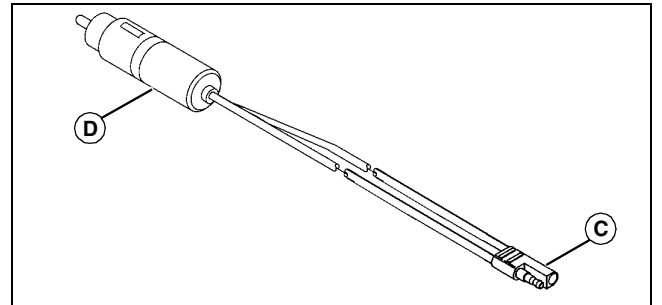

MX35122

3. Connect other end of main harness to 12 volt plug adapter harness (C), and plug 12 volt plug (D) into accessory outlet on dash panel.

Preparing Vehicle

Machine Requirements

Sprayer Weight:

- 15 Gallon Sprayer, Filled with liquid is 68 kg (150 lb)
- 25 Gallon Sprayer, Filled with liquid is 107 kg (235 lb)
- 40 Gallon Sprayer, Filled with liquid is 166 kg (365 lb)

Make sure machine tire pressure is correct. (See your machine operator's manual for the correct pressure.)

Your machine requires the following:

- 12-Volt Outlet

REMOVING AND STORING

Removing and Storing

Removing Sprayer

1. Park machine safely. (See Parking Safely in the Safety section.)



CAUTION: Avoid injury! To avoid chemical injury:

- Wear protective clothes, gloves and goggles when handling sprayer.
- Do not store sprayer with chemicals in tank.
- If spray comes in contact with your body, immediately follow directions on chemical container pertaining to spray material.

2. Empty the sprayer tank. (See Dispose of Chemicals Properly in the SAFETY section.)

3. Disconnect main harness from the sprayer pump, leaving switch harness connected to machine.

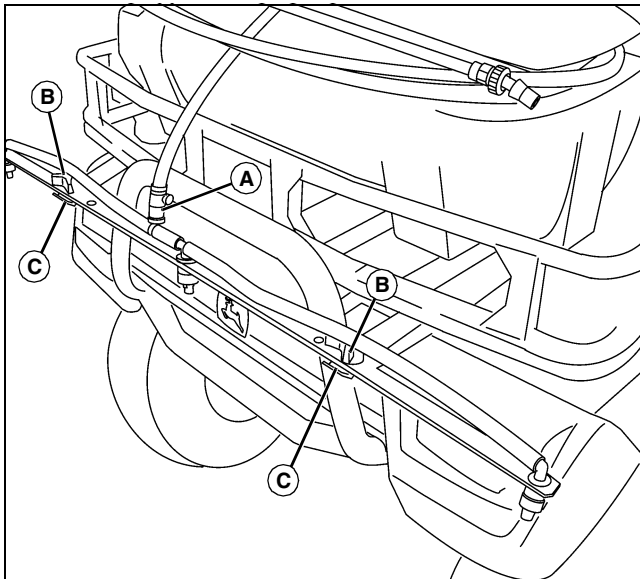

Picture Note: 15 Gallon sprayer shown.

4. Disconnect connection hose (A) on center coupling on boom assembly hose.

5. Loosen locking knobs (B), and remove sprayer boom assembly from boom support brackets (C).

6. Remove sprayer tank:

15 Gallon Sprayer

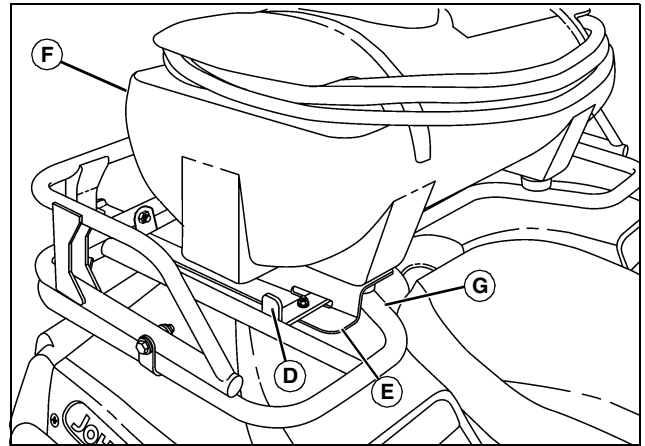

- Turn lever (D) parallel with Z bracket (E), and remove sprayer tank assembly (F) from rear rack (G).

25 Gallon Sprayer for Compact Series Gators and EXT Model UATV

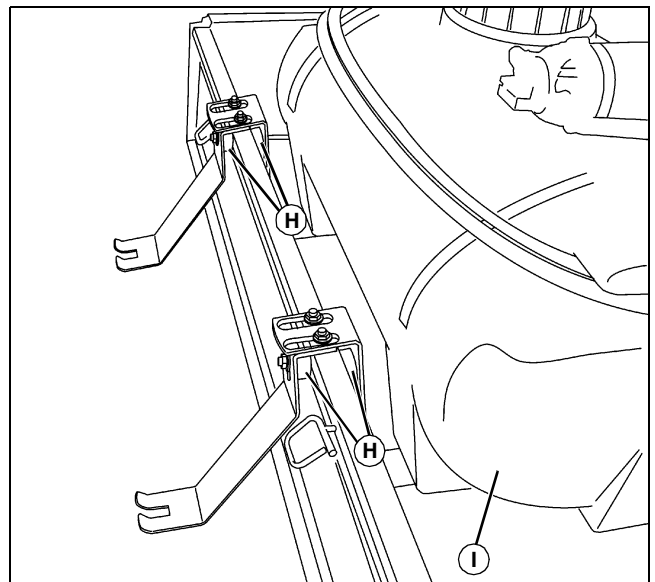

- Raise right and left sides of sprayer tank to remove bumpers (H) from tailgate, and remove entire sprayer tank assembly (I) from cargo box.

OPERATING

25 and 40 Gallon Sprayer for Traditional and High Performance Series Gators

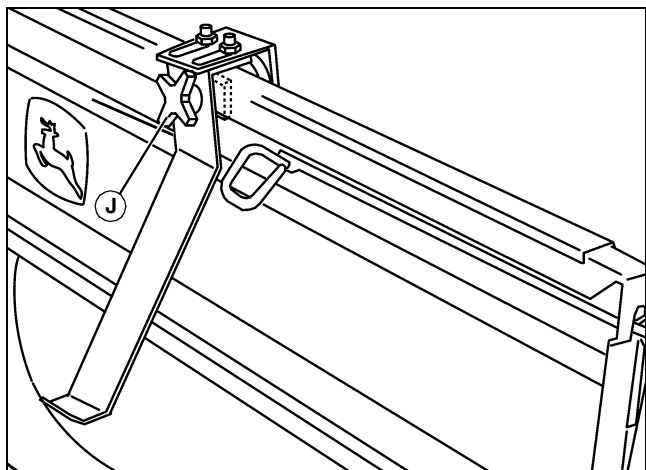

- Loosen locking knobs (J) until they slide down free of the tailgate to remove entire sprayer tank assembly from cargo box.

Store Sprayer Safely



CAUTION: Avoid injury! To avoid chemical injury:

- Wear protective clothes, gloves and goggles when handling sprayer.
- Do not store sprayer with chemicals in tank.
- If spray comes in contact with your body, immediately follow directions on chemical container pertaining to spray material.

1. Pump all spray material from tank. (See Dispose of Chemicals Properly in the SAFETY section.)
2. Rinse tank, pump, spray wand and all hoses thoroughly with fresh clean water.
3. Repeat step 2 several times.
4. Wipe out sump with a clean cloth or paper towel.
5. Drain hoses and pump filter.
6. Check sprayer for worn or damaged parts. Replace parts as needed.
7. Tighten loose hardware.
8. Store sprayer in a place where it will not freeze.

Operating

Filling Sprayer Tank



CAUTION: Avoid injury! Chemicals can be dangerous. Avoid injury to operator or bystanders:

- Read chemical container label for mixing and handling instructions. A Material Safety Data Sheet (MSDS) should be supplied by the chemical dealer and provides proper safety information.
- Wear proper clothing and safety equipment while handling or applying spray chemicals.
- Wear a full covering of clothing, protective goggles and rubber gloves.
- Prohibit all smoking, drinking, and eating around chemicals.
- When filling tank, never allow end of water hose to contact chemical mixture.

IMPORTANT: Avoid damage! Clean any spills immediately with clean water prior to operating the sprayer.

NOTE: There is no drain plug provided for draining sprayer tank. When filling tank, consider the area to be sprayed and amount of solution required to complete the task.

1. Clean area around tank filler cap to prevent tank contamination.
2. Remove tank filler cap and fill tank.
3. Install tank filler cap.

Draining and Cleaning Sprayer Tank

IMPORTANT: Avoid damage!

- Proper disposal of excess spray is very important. Dilute it with water and apply it to area previously treated.
- Never dump excess into a storm drain or near a lake or stream.

1. Remove tank filler cap, and empty sprayer tank:
 - Empty remaining solution into an appropriated container for proper disposal.
 - Dilute remaining solution with water and apply it to the area previously treated.
2. Spray all inside surfaces of tank with low pressure garden hose to remove any remaining solution. Rinse sprayer tank, pump, sprayer wand and all hoses thoroughly with fresh clean water. Rinse several times to make sure sprayer tank is clean and free of chemicals.
3. Once the tank is empty, wipe out inside of sprayer tank with a clean cloth or paper towel.
4. Install filler cap.

Spraying Tips

- Do not let sprayer run in one spot.
- Do not over spray when you use weed killers.
- Liquid spray material is recommended. Sprayer does not agitate wettable powders.
- Timely applications of a smaller dosage are better than large

OPERATING

applications.

- Turn sprayer off during turns to avoid double spraying.
- Fill sprayer where spills cannot harm grass.
- Follow manufacturer's recommendations for application of specific chemicals.
- Stop sprayer when tank is empty.

Checking Machine Ground Speed

1. Check ground speed in an open area.
2. Measure a test area that is 30.5 m (100 ft) in length.
3. Operate machine at a low speed and drive the machine the test distance. Record the time needed to travel that distance.
4. Make three passes, recording the time for each pass. The average time should be 23 seconds to achieve the recommended operating speed range.
5. Adjust accordingly to achieve recommended speed range.

The recommended operating speed is 4.8 km/h (3 mph). At this speed, the average time traveling the test distance should be 23 seconds.

General Spraying Information

15 Gallon Sprayer Application:

The 15 Gallon Sprayer operates at a fixed pressure of 620 kPa (90 psi). This yields 10 minutes of spraying time using the spray boom or 25 minutes of spraying time using the sprayer wand. When operating the spray boom, plan on driving about 4.8 km/h (3 mph) or 80 m/min. (264 fpm). That provides 2453 m² (26,400 sq ft) of spray coverage per tank. Plan on about 10 percent overlap, so put enough chemical in the tank for 2207 m² (23,760 sq ft) of spray coverage.

25 Gallon Sprayer Application:

The 25 Gallon Sprayer operates at a fixed pressure of 620 kPa (90 psi). This yields 18 minutes of spraying time using the spray boom or 42 minutes of spraying time using the sprayer wand. When operating the spray boom, plan on driving about 4.8 km/h (3.0 mph) or 80 m/min. (264 fpm). That provides 4415 m² (47,520 sq ft) of spray coverage per tank. Plan on about 10 percent overlap, so put enough chemical in the tank for 3973 m² (42,768 sq ft) of spray coverage.

40 Gallon Sprayer Application:

The 40 Gallon Sprayer operates at a fixed pressure of 620 kPa (90 psi). This yields 29 minutes of spraying time using the spray boom or 68 minutes of spraying time using the sprayer wand. When operating the spray boom, plan on driving about 4.8 km/h (3.0 mph) or 80 m/min. (264 fpm). That provides 7063 m² (76,032 sq ft) of spray coverage per tank. Plan on about 10 percent overlap, so put enough chemical in the tank for 6363 m² (68,500 sq ft) of spray coverage.

Adjusting Tip Spray Pattern

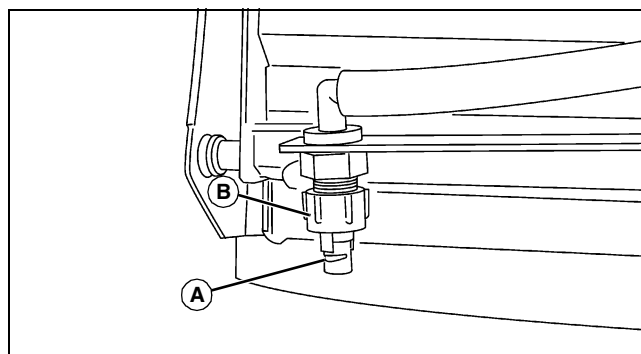

MX35119

1. Check spray tips:
 - Center spray tip should be aligned with boom, and spray straight back from boom.
 - Outer two spray tips (A) should be angled out 30 degrees, as shown.
2. If necessary, loosen spray tip cap nut (B). Align spray tip (A) and tighten cap nut.
3. Test spray pattern with water on driveway or sidewalk, and adjust as necessary. There should be some spray overlap between each tip and the spray patterns should be consistent.

Starting and Stopping Sprayer



CAUTION: Avoid injury! Standing in a machine while it is moving can result in loss of balance and falling from machine. Never operate machine while standing. For machines that can carry passengers, the passenger must remain seated at all times.

IMPORTANT: Avoid damage! Operate sprayer with transport vehicle running to avoid discharging the battery.

NOTE: The sprayer pump to accessory outlet hookup is a direct electrical connection. Shutting off the transport vehicle does not prevent operation of the sprayer pump. To avoid accidental spraying, disconnect the pump connection before leaving the sprayer.

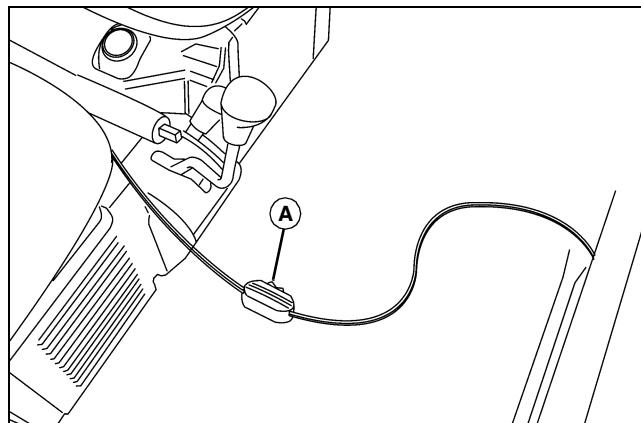

MX35120

Picture Note: 25 Gallon on UATV shown.

1. Push switch (A) to ON position to start the sprayer.
2. Push switch (A) to OFF position to stop the sprayer.

SERVICE

Selecting Spray Wand or Boom Nozzles

NOTE: Shut-off valve lever (A) has two positions:

- **ON POSITION** - Lever is parallel with hose. Pump flow is directed to the sprayer boom.
- **OFF POSITION** - Lever is perpendicular with hose. Pump flow is directed to the spray wand.

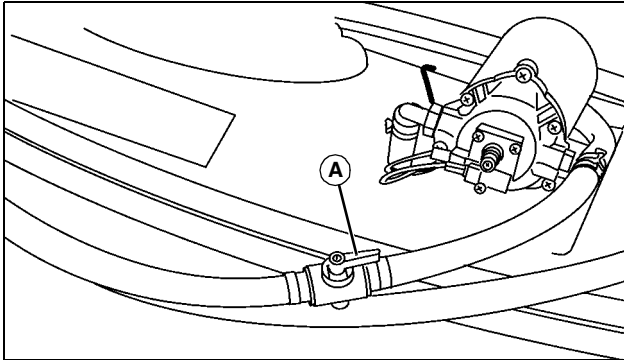

MX34863

- To use spray wand: Turn lever (A) so that it is perpendicular with hose. You can now use the spray wand for spraying.
- To use sprayer boom: Turn lever (A) so that it is parallel with hose. Turn pump on and operate spray wand to remove all air from hose. After spray wand sprays liquid, turn pump off. Turn lever (A) so that it is parallel with hose. You can now use the boom nozzles for spraying.

Using Spray Wand



CAUTION: Avoid injury! Standing in a machine while it is moving can result in loss of balance and falling from machine. Never operate machine while standing. For machines that can carry passengers, the passenger must remain seated at all times.

NOTE: Spray wand should only be used when operator is seated.

1. Turn valve to select spray wand operation.

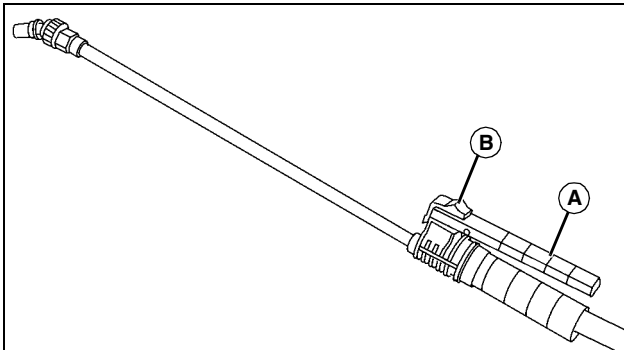

MX34866

2. Squeeze handle (A) to spray.
3. Push lock (B) forward to lock handle in the on position.

NOTE: Removal of nozzle (D) allows for quick cleaning or rinsing of sprayer tank.

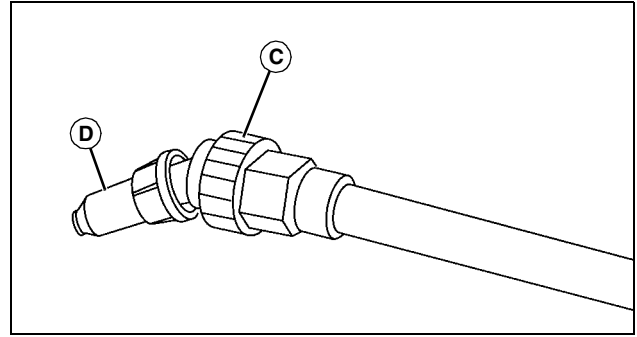

MX34867

4. Adjust nozzle:

- Nozzle Angle - Loosen locknut (C). Turn nozzle (D) as desired and tighten locknut.
- Nozzle Spray Pattern - To change the spray pattern, tighten or loosen nozzle (D) as desired.

Lifting Sprayer Safely

- Use caution when lifting the sprayer to help prevent possible injury.
- When filled with liquid, the 15 gallon sprayer weighs 68 kg (150 lb), the 25 gallon sprayer weighs 107 kg (235 lb) and the 40 gallon sprayer weighs 166 kg (365 lb). Empty tank before attempting to lift.

Transporting Sprayer Safely

- Use caution when transporting the sprayer to help prevent possible injury.
- Push pump switch to off position.
- When filled with liquid, the 15 gallon sprayer weighs 68 kg (150 lb), the 25 gallon sprayer weighs 107 kg (235 lb) and the 40 gallon sprayer weighs 166 kg (365 lb). This extra weight on the back of a machine could change the stability of the machine.

Service

Cleaning Spray Nozzle

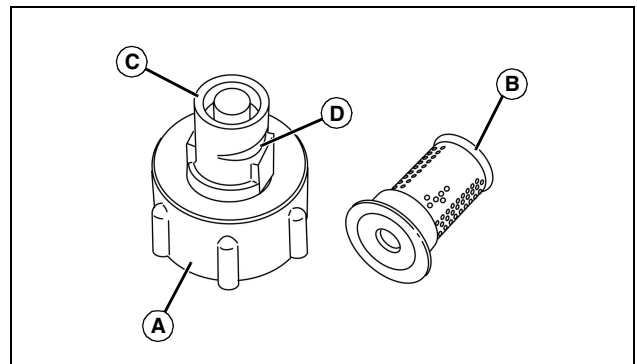

MX35121

1. Remove spray nozzle (A) from sprayer.
2. Disassemble filter (B) and spray tip (C).

NOTE: Do not use a wire to clean opening (D) in spray tip.

3. Wash filter and spray tip in a non-flammable solvent.

TROUBLESHOOTING

- Put spray tip in spray nozzle.
- Put flat side of filter in spray nozzle.
- Install assembly on sprayer and tighten nozzle.

Cleaning Pump Suction Screen

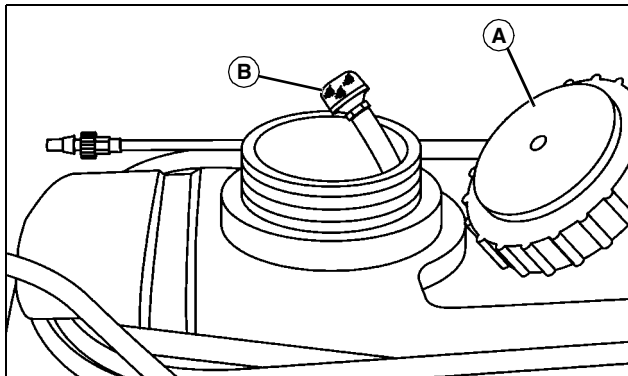

MX34869

- Remove tank cover (A).
- Locate suction screen (B) inside sprayer tank.
- If necessary, unscrew suction screen and clean with liquid detergent and warm water.
- If suction screen was removed, install on suction hose and position in lowest depression inside tank.
- Install and tighten tank cover.

Cleaning Spray Wand Nozzle

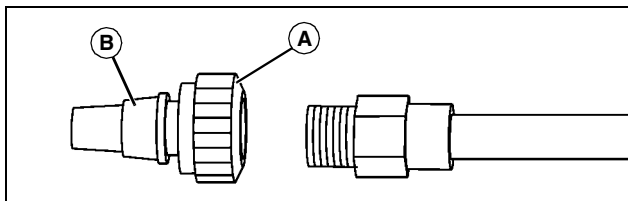

MX34870

- Remove locknut (A) and nozzle (B) from spray wand.
- Wash nozzle with liquid detergent and warm water.
- Install and tighten nozzle.

Changing Fuse

IMPORTANT: Avoid damage! The electrical system may be damaged if incorrect replacement fuses are used. Replace the bad fuse with a fuse of the same amp rating.

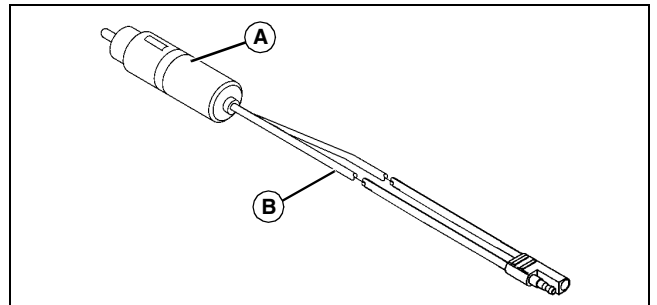

MX35122

- Unscrew two halves of fuse plug (A), and remove fuse on front 12 volt plug adapter harness (B).
- Install new 15 amp fuse, and screw together the two halves of fuse plug.

Adjusting Pump

- Park machine where spray will do no damage.
- Stop engine.
- Start sprayer.

IMPORTANT: Avoid damage! To prevent pump damage, stop turning wrench as soon as pump runs smoothly.

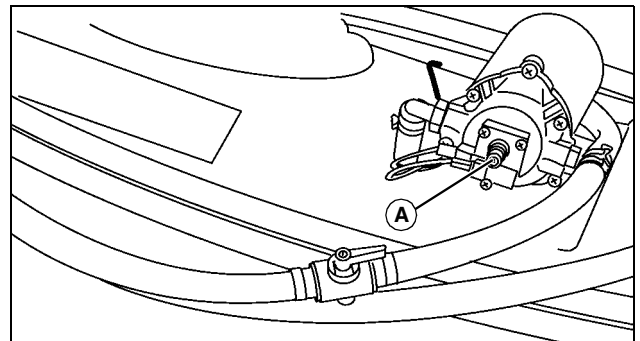

MX34863

- Using a hex wrench, turn set-screw (A) clockwise until pump runs smoothly.
- Stop sprayer.

Troubleshooting

Using Troubleshooting Chart

If you are experiencing a problem that is not listed in this chart, see your authorized dealer for service.

When you have checked all the possible causes listed and you are still experiencing the problem, see your authorized dealer.

SPECIFICATIONS

Using Troubleshooting Chart

IF	CHECK
Pump Loses Suction.	Clean Pump suction screen. Check tank fill level. Fill tank. Clean or replace pump. Check for loose pump fittings.
Pump Capacity Decreased.	Clean pump suction screen. Clean spray nozzle(s). Selection lever is not completely turned on, or is in the OFF position.
Poor Spray Pattern.	Clean spray nozzles. Adjust nozzle height. Align spray tips with boom.
Pump Vibrates or Spray Pulses.	Adjust pump.
Pump Does Not Work.	Check wiring connections. Check machine battery. Clean debris from pump. Check pump switch. Check pump motor. Check fuse on 12 volt plug adapter harness. Adjust pump.

Full 68 kg (150 lb)

Weight - 25 Gallon Sprayer:

Empty 16 kg (35 lb)

Full 107 kg (235 lb)

Weight - 40 Gallon Sprayer:

Empty 20 kg (45 lb)

Full 166 kg (365 lb)

Getting Quality Service

John Deere Quality Continues with Quality Service

John Deere provides a process to handle your questions or problems, should they arise, to ensure that product quality continues with your John Deere dealer's parts and service support.

Follow the steps below to get answers to any questions you may have about your product.

1. Refer to your attachment and machine operator manuals.
2. Contact your John Deere dealer with unanswered questions.
3. In North America or Canada, call the John Deere Customer Contact Center.
 - Call 1-800-537-8233 and provide product serial number and model number.

Specifications

Model 15, 25 and 40 Gallon Sprayer

Tank - 15 Gallon57 L (15 gallon)

Tank - 25 Gallon95 L (25 gallon)

Tank - 40 Gallon151 L (40 gallon)

Pump:

Type Electric Motor and Diaphragm

ManufacturerShur Flo

Current Draw7 amp

Fuse15 amp

System Pressure 620 kPa (90 psi)

Spray Rate 3.8 L/min. (1.0 gal/min.)

Suction Hose Strainer Stainless Steel

Spray Tip Material Plastic

Sprayer Wand:

Material Plastic

Adjustment Fan To Stream

Sprayer:

Spraying Width 305 cm (120 in.)

Weight - 15 Gallon Sprayer:

Empty 14 kg (30 lb)

GETTING QUALITY SERVICE
